

# NISSAN TITAN 2004

## With Storage Door Piece

### Set Part # 70902



### Step 1:

#### Prior to Installation:

- A) **Fit:** Verify the fit of the flares to vehicle. (Some filing, sanding, or cutting may be necessary to ensure proper fit).
- B) **Painting:** (Optional) if paint is desired it must be done prior to installing flares on the vehicle clean outer surface with a good grade degreaser. **DO NOT USE LACQUER THINNER OR ENAMEL REDUCER AS A DEGREASER.** Wipe outer surface thoroughly with a tack rag prior to paint. Paint flares using a high quality enamel, or polyurethane automotive paint. (Application of a primer coat is optional) If painting edge trim (not recommended) use a flex additive.
- C) **Performance:** Using larger Tires may increase the area required to turn the vehicle. Some Tire/Rim combinations may require lowering bump stops and or installing steering stops to prevent tire from contacting flare.
- D) **Exhaust System:** Modifications may be necessary to maintain a minimum 4" clearance between flares and exhaust pipes. (Exhaust gases should **not vent directly onto flares**)
- E) **Chrome Decals:** On Front fenders, pry off V, 8 and Endurance decals with a non-marring plastic putty knife. (Decals may be put back on after flare install is complete. New double stick foam tape will be required.)
- F) **Mud Flaps:** Remove all mud flaps from vehicle, saving the Phillips screws for flare install.

#### TOOLS FOR EASY INSTALLATION

- Utility Knife
- Socket wrench
- #10 Socket
- Drive bit holder for socket wrench
- #2 Phillips Drive bit
- Automotive trim pry tool
- Vinyl or Plastic putty knife

---

## FLARE INSTALLATION PROCEDURES

### Step 2: Edge Trim Installation (See Illustration #1)

- A) Peel two to three inches of red vinyl backing away from edge trim tape and affix to flare at one end. (With Adhesive Strip to the inside of flare, see illustration #1)
- B) Press edge trim into place along edge of flare in one-foot increments, pulling red vinyl backing free as you continue to work your way around the flare.

Illustration #1  
Flare and Edge Trim

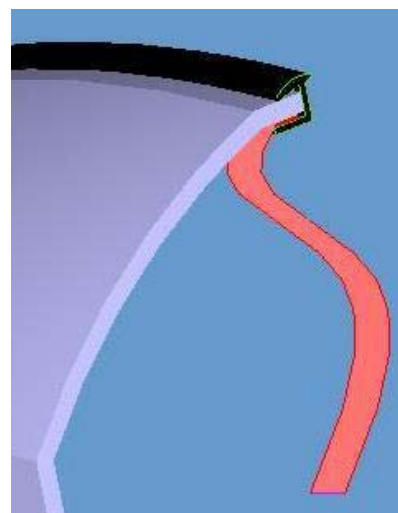

### Step 3: Front Flare Installation (See Illustration # 2 & 3)

- A) Remove factory mud flaps if installed, and one extra unpainted screw above mud flap. (Save screws).
- B) (If no mud flaps were removed, remove two unpainted factory screws per side). (See illustration #3)
- C) Hold flare in position on fender with moderate pressure. Line up the two lowest holes in flare with the factory holes and start the two factory screws. (Leave loose). (See illustration #3).
- D) Install three clips over fender lip, lining up the hole in clips with the holes in flare. (See illustration #2 and 3).
- E) Start clip screws in each clip, but leave loose.
- F) Insuring the flare is properly located on fender, apply moderate pressure to outside surface of flare, and tighten screws, beginning with the two factory screws working toward the front of the fender flare.
- G) Repeat for other side.

### Illustration #2 Cross Section of Flare and Fender With Clip and Screw

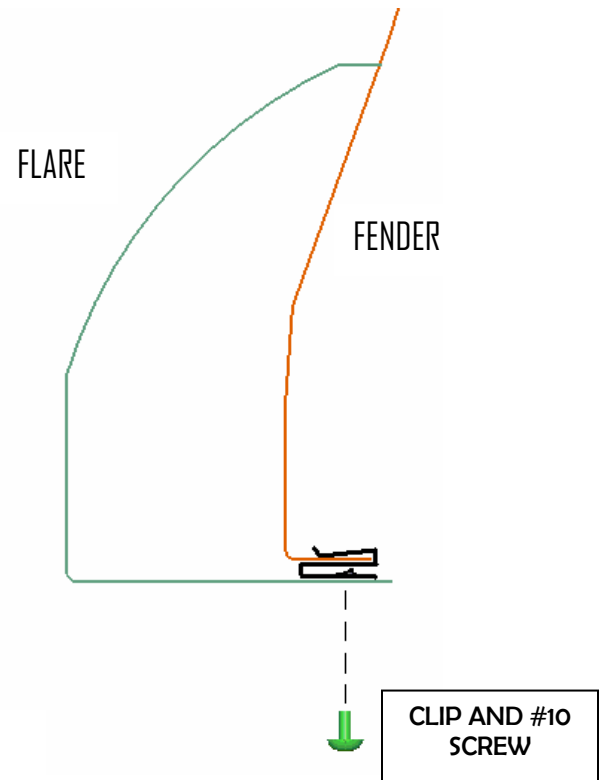

### Illustration #3 Driver Front Fender

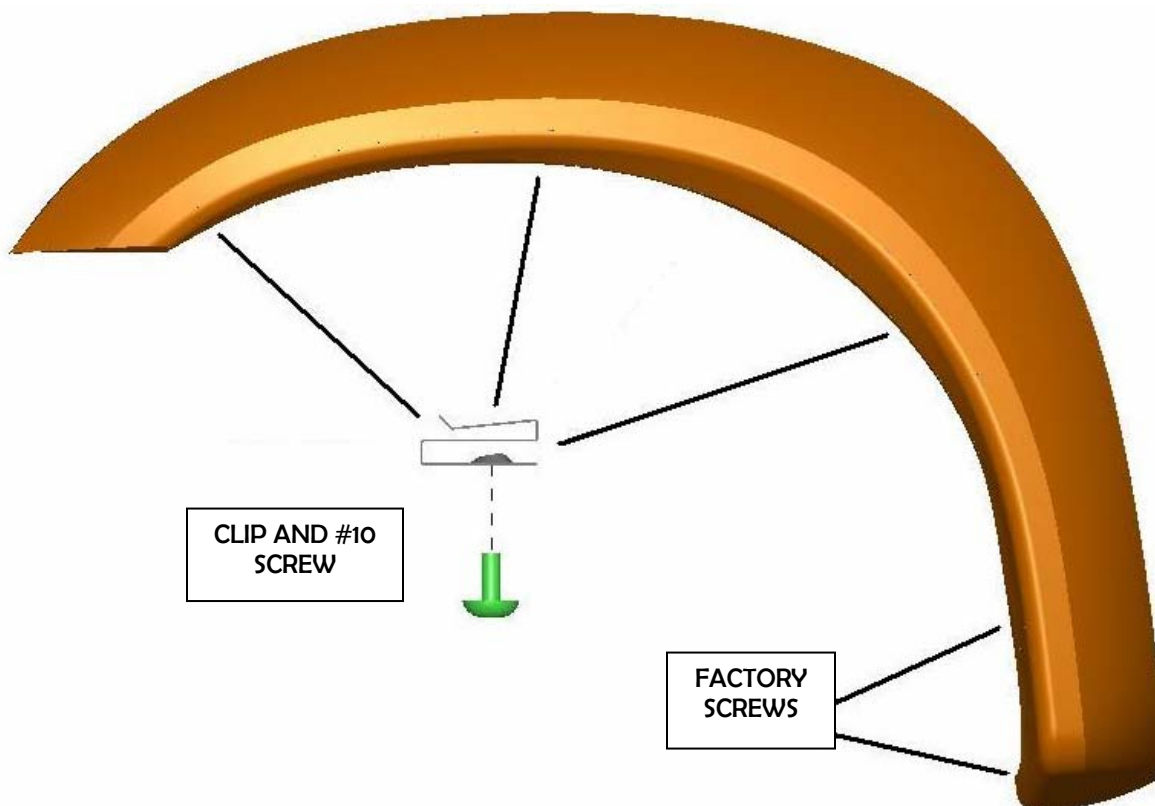

#### Step 4: Rear Flare Installation (See Illustrations # 2, 4 & 5)

- A) Remove factory mud flaps if installed, and one extra unpainted screw above mud flap. (Save screws).
- B) Hold passenger side (RR) flare in position on fender with moderate pressure. Line up the three lowest holes in fender with the holes in flare and start the three factory screws. (Leave loose). (See illustration #4).
- C) Install four clips over fender lip, lining up the hole in clips with the holes in the flare. (See illustration #2 & 4).
- D) Start clip screws in each clip, but leave loose.
- E) Insuring the flare is properly located on fender, apply moderate pressure to outside surface of flare, and tighten screws, beginning with the three factory screws working toward the front of the fender flare.
- F) Hold driver side (LR) flare up to fender with moderate pressure and ensure it is positioned correctly with the gas door. (See illustration #5)
- G) Place clips over fender lip, lining up the hole in clips with the holes in flare. (See illustration #2 & 5)
- H) Start screws but leave loose.
- K) Insuring the flare is properly located on fender, apply moderate pressure to outside surface of flare, and tighten screws, beginning with the lower front screw, working toward the access door. (See illustration #5).

Illustration # 4  
Rear Passenger Side Flare

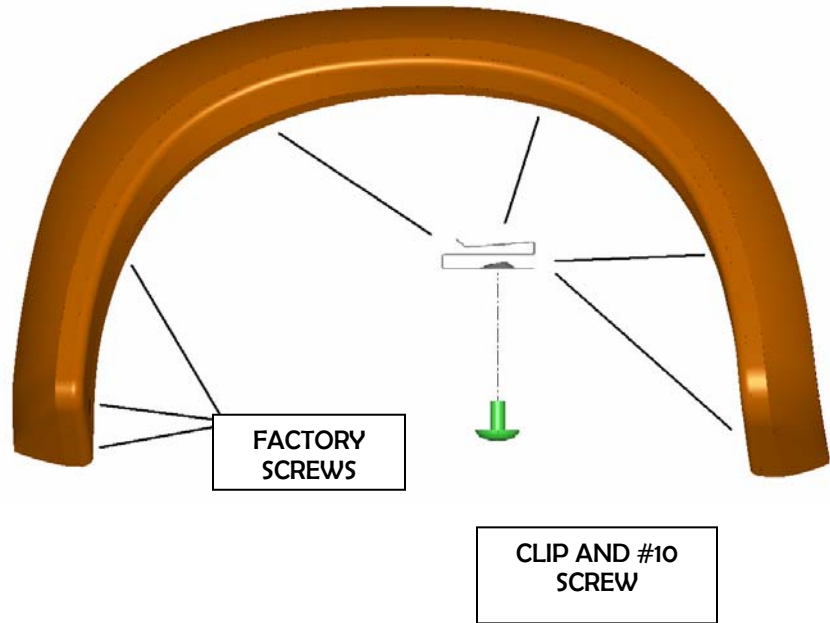
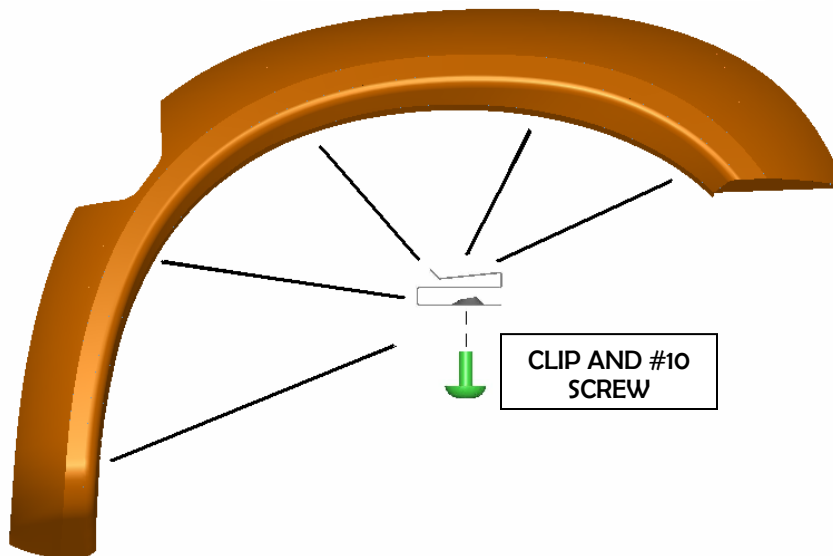

Illustration #5  
Rear Driver Side Flare

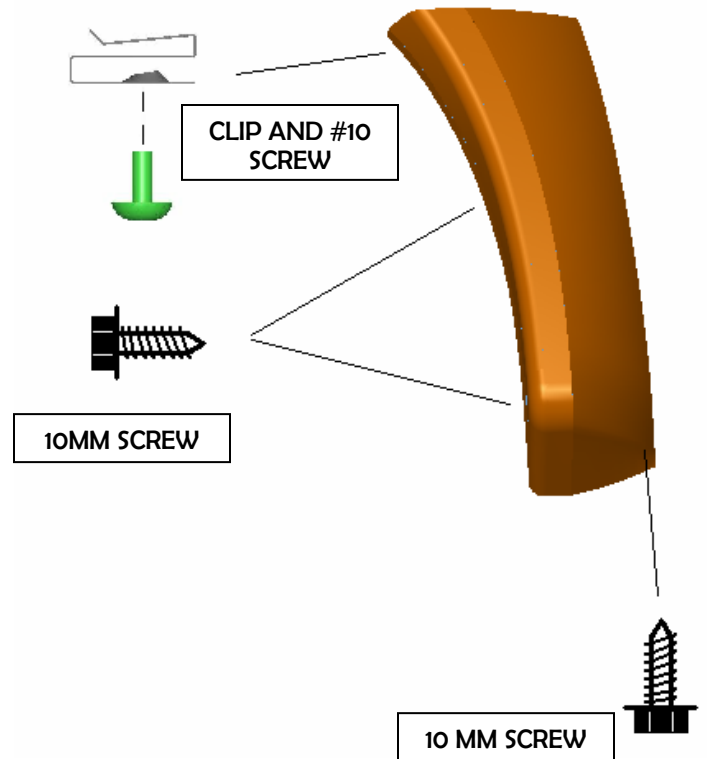

**Illustration #6**  
**Access Door Flare Without Mud Flaps**

**Step 5: Rear Door Installation**  
**Without Mud flaps**

**(See Illustration #6)**

- A) On the bottom of the door, pry out the Christmas Tree fastener.
- B) Open access door.
- C) Remove edge protector from door lip and discard.
- D) Insert two plastic grommets into the square holes on the edge of the door and one into the Christmas tree hole .
- E) Hold the door piece flare up to the door and line up the holes in the flare with the three factory holes. **(See illustration #6)**
- F) Start the supplied 10mm screws into the grommets, but leave loose.
- G) Slide a clip over the door lip at the top of the door where the indent in the flare is. (The clip will be at a slight angle).
- H) Start screw, but leave loose.
- I) Insuring the door piece is properly located on door, apply moderate pressure to outside surface of flare, and tighten the 10mm screws, then the clip screw.



**Step 6: Rear Door Installation**  
**With Factory Mud flaps**

**(See Illustration #7)**

- A) Remove the factory mud flap and save the screws.
- B) Pry out the factory grommet on the lower surface of the door and install a supplied grommet.
- C) Hold the door piece flare up to the door and line up the holes in the flare with the three factory holes.
- D) Start the supplied 10mm screws into the factory grommets, but leave loose.
- E) Slide a clip over the door lip at the top of the door where the indent in the flare is. (The clip will be at a slight angle).
- F) Start screw, but leave loose.
- G) Insuring the door piece is properly located on door, apply moderate pressure to outside surface of flare, and tighten the 10mm screws, then the clip screw.

**Illustration #7**  
**Access Door Flare With Mud Flaps**

